

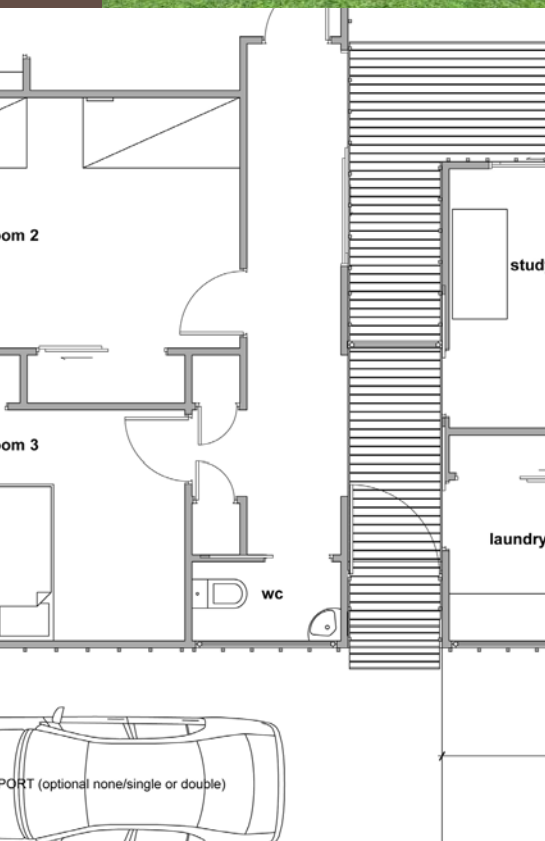

Aotearoa Housing



Aotearoa Housing is a student design proposal for an affordable housing option. It is aimed towards providing a higher quality and standard of living for Maori. It is envisaged that this will be built in transportable units that can be built and then transported or shipped to the site.

This design is a three bedroom residence comprising of two separate pavilions that are connected by a boardwalk style decking. This allows the user to separate living and bedroom areas.

Three colour schemes are proposed that will be available to give people choice and the opportunity to personalise their home. All three colour options are aiming for a funky, modern style of living.

The vibrant use of colour gives the users a clean, fresh environment and makes the buildings stand out from the standard brick and tile homes that are all too common now. The green colour option represents the importance and value of land, plant and greenery in Maori values. The blue is representative of the spiritual attachment to water. The red is a reference to the symbolic red used in carving and patterning by Maori.

Colour Selection: Renee Holtom

Colours Used: (Kakariki) Resene Black White, Resene Kombi, Resene Limed Oak, Resene Limerick (Kotare) Resene Calypso, Resene Endeavour, Resene Smokey Ash (Kokowai) Resene Bullseye, Resene Crowshead, Resene Pulse



 Resene Double Buffalo

Kombi

Limed Oak

Black White

Limerick

Calypso

Smokey Ash

Endeavour

Bullseye

Crowshead

Pulse