



ASB Cameron Road

Tauranga

ASB Cameron Road has exciting corporate offices using industrial colours, steel, containers and rubber to anchor it to its location of Tauranga.

A scientific approach was taken to calculate the types and numbers of work settings required. This calculation was tuned to the types of work undertaken by staff as well as being able to accommodate fluctuating staff numbers. The client engaged the Dutch workplace strategy firm Veldhoen and Co to undertake detailed and lengthy observations of space use and surveys of staff at the previous premises. This raw data formed the basis of calculations that arrived at the strategy for Cameron Road. The strategy requires all work settings to be completely shared and varied.

The workplace is completely shared in an Activities Based Working (ABW) environment. Along with the science above, the space has been given an industrial and port theme using steel, containers, rubber and industrial hues. A large industrial steel stair designed around the portside trusses and ship gantries links the two floors together via a top lit atrium space.

Traditional office partitions have been rejected. Transparent screens, high backed lounges, differing surface materials, specific lighting levels and acoustic treatments define spaces. Industrial typeface graphics have been created for the walls and glazing to reinforce the theming and originality across the differing internal surfaces.

The inspiration for the formal language used in the project was the industrial Port of Tauranga.

At ground level using **Resene Wan White** on the walls and **Resene Alabaster** on ceilings lightens up the floor plate and surrounds with the steel stair highlighted delicately with Resene Armourcote in **Resene Double Kandinsky** taking you up through the atrium to the start of the colour story playing out above.

On the upper level the palette of colours found in the stacked containers in the Port is only the kick start for the selection. From there a bid for the singular ones, the earthy burnt orange **Resene Flashback**, the sea like blue **Resene Calypso** and the misty white cloud **Resene Iron** become the main players.



The combination is easy, the cloudy **Resene Iron** takes over the biggest 'containers' and **Resene Flashback** and **Resene Calypso** play with each other.

All the surrounds are then reduced to the neutral tones of **Resene Wan White** and **Resene Alabaster** for walls, ceilings and doors with a touch of **Resene Quarter Akaroa**.

Everything is a fine balance, giving



 Resene Flashback





the spectator enough for them to start imagining it without becoming a stage set.

In the Port it is relatively easy to pile up real containers one on top of each other. It is not so to redefine volumes inside of a building to create the 'feel' of a pile of containers.

In this project big plasterboard bulkheads are proportioned and composed and then a painted light skin, made of aluminium extrusions and polycarbonate cladding, dresses them as containers. The complex and extensive steel structure that supports

them is hidden away behind impossible cantilevering container shapes.

The large sloping ceiling plane is totally independent of the roof structure, supported by a hidden 18 metre long steel truss. The single piece, 8.5 metres long, and the few thousand kilogram staircase made off site was rolled in through the front door and lifted in position with jacks. These elements pay homage to the kind of activities that are closer to the Port than to an interior building fit-out.

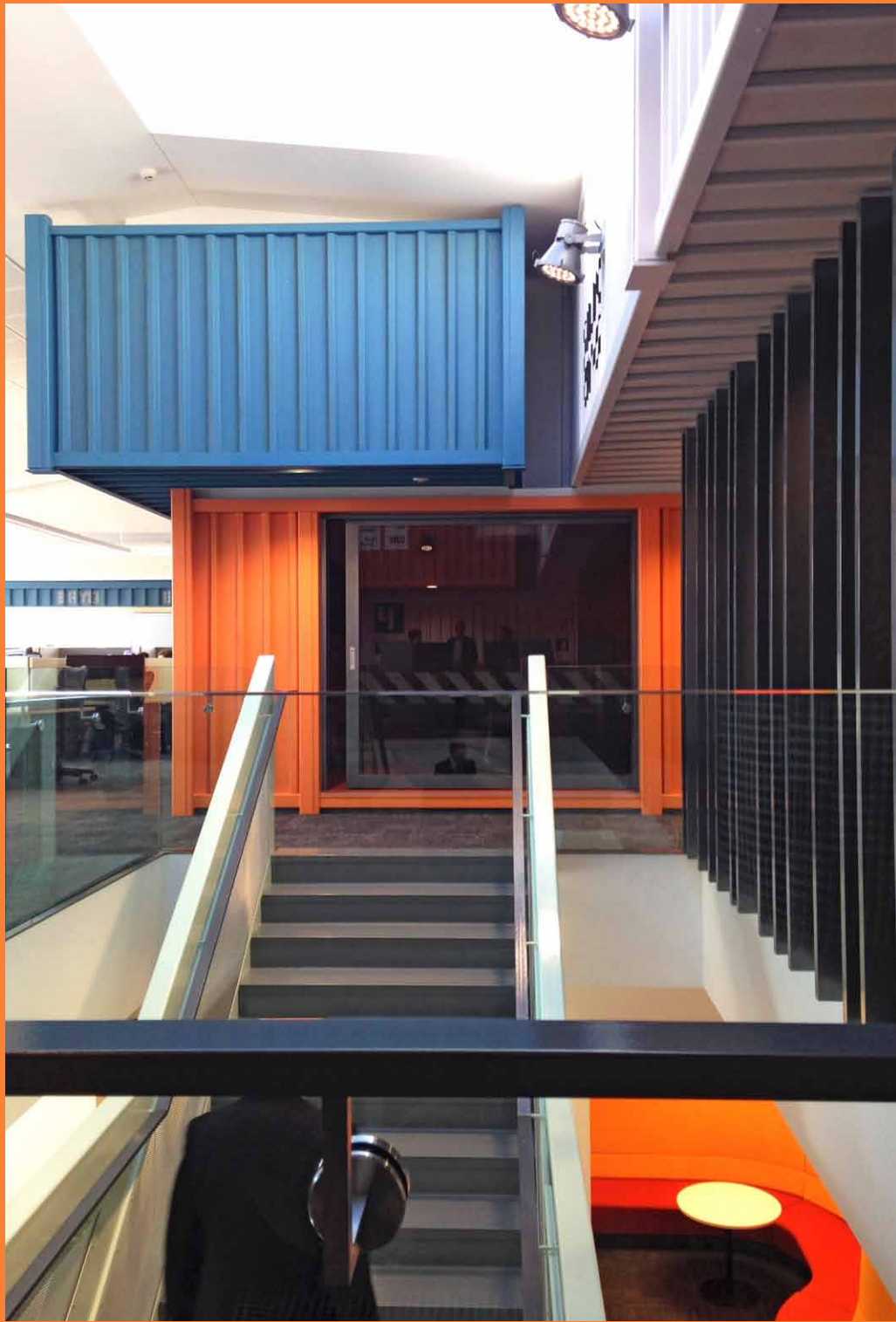

Acoustic design: Marshall Day Ltd www.marshallday.com

Architectural specifier: CPRW Fisher Architects www.cprwfisher.co.nz

Base building architect: ADG Ltd

Base building engineer: Redco Ltd www.redco.co.nz