



# Make a home for your tools

Mark Rayner shows how to build a simple storage cupboard for gardening equipment.

## You will need:

- Four old louvre cupboard doors
- 22mm plywood
- 25mm x 25mm timber battening
- An approx 250mm length of 50mm x 50mm timber
- Screwdriver
- Saw
- Drill
- Paintbrush

- Exterior PVA glue
- 40mm zinc-plated or stainless steel screws
- 75mm zinc-plated or stainless steel screws
- Zinc plated, stainless steel or galvanised hinges
- Zinc-plated, stainless steel or galvanised latch or lock
- Resene Quick Dry water-borne primer undercoat

- Resene Lumbersider tinted to Resene Chelsea Cucumber

**Resene**  
the paint the professionals use  
For more on paints  
phone 0800 RESENE  
or visit [www.resene.co.nz](http://www.resene.co.nz)



**To get the look:** Mark painted the background wall with Resene Lumbersider tinted to Resene Pale Prim.

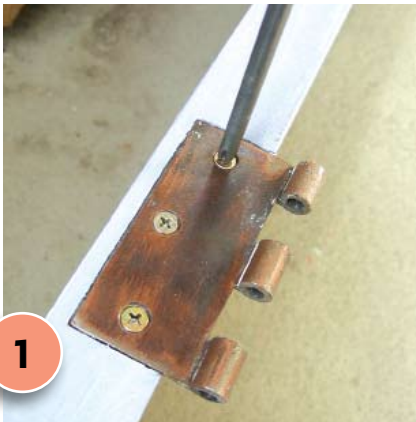

1

Remove the old hinges from the cupboard doors, as shown.



2

Attach three of the cupboard doors together with PVA glue and screws, as shown, to form the sides and back of the unit.



3

Measure and cut a piece of plywood to form the base and fix into position with PVA glue and screws. Measure and cut a piece of plywood to form the roof.

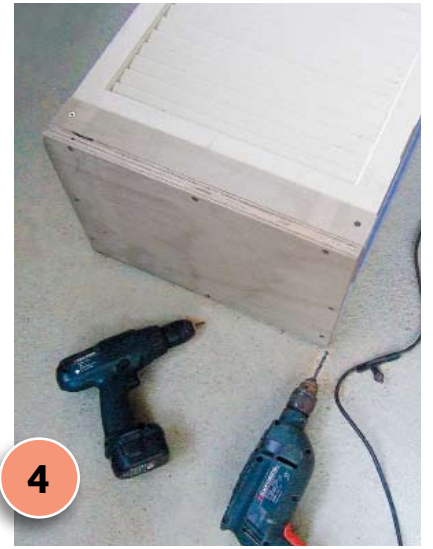

4

Fix the roof in place with PVA glue and screws. Cut a strip of plywood to fill the space across the unit's back and front (this isn't necessary if your doors are the same height). Fix the unit's door in place with the hinges and screws.



5

Measure and cut six lengths of 25mm battening to form the shelf supports. Fix to the inside of both side walls of the unit with PVA glue and screws. Measure and cut three pieces of plywood to form the shelves.



6

Measure and cut four 50mm lengths of 50mm timber and fix to the base of the toolshed with PVA glue and screws to form the feet.



7

Lightly sand the cupboard doors. Sand and spot prime with Resene Quick Dry any bare wood where old paint has chipped. Prime all the sides of the plywood with Resene Quick Dry. Allow to dry for two hours.



8

Apply two coats of Resene Chelsea Cucumber to the entire structure. Allow two hours for each coat to dry. Fit the shelves into position on the side supports. Fit the latch or lock.

**Top tip:** When using screws, always drill pilot holes first to prevent wood and plywood splitting.