



# Bird feeder

## You will need

- Pallet top deck board
- 4 x 40mm screws to attach the roof to the main body
- 1 eyelet screw to hang
- 3 nails to use as perches
- Quick Dry Waterborne Primer Undercoat paint: Resene Sweet Corn

**Cost:** \$3 excluding Resene products.

## Step 1

Mark one end of a 100mm top deck board with two 20-degree cut lines that meet in the centre.

Measure down the length of the board by 150mm, then mark two more 20-degree cut lines that mirror the other end.

Measure in 70mm and mark a point for drilling the hole for the fruit.

## Step 2

Clamp the deck board down and cut out the 70mm hole with a hole saw.

## Step 3

Drill a hole through each side of the deck board that crosses through the

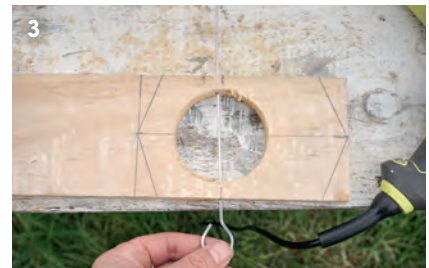

middle of the fruit hole to support the steel fruit skewer.

Cut the bird feeder out off the deck board using the marked lines as your guide.

**Step 4** To make the “roof”, use the 20-degree cut on the main body of the bird feeder as a guide to mark the angle onto the edge of a deck board. Then cut that piece 120mm long. Cut that piece in half along its length to make two roof pieces.

Glue and screw the roof onto the top end of the bird feeder body. Then drill and screw an eyelet screw into the top of the roof for hanging, then hammer some nails into the bottom for perches.