

Tiered plant stand

A great project for your deck, balcony or conservatory.

You will need

- 2 linear metres of 45mm x 45mm timber for exterior use. I have used Cedar Tight Knot dressed timber.
- 25mm exterior plywood for 3 circles measuring 750mm x 250mm (these can be squares for ease).
- 11 x 65mm stainless steel screws.
- Your choice of Resene finish.

Tools

- Measure tape and pencil
- Square
- Mitre Saw or hand saw
- Jigsaw (if required)
- Clamp
- Drill with 4mm drill bit and square bit
- Sandpaper
- Paintbrushes and roller

Health & safety When using power tools always wear goggles and ear defenders, and ensure all jewellery is tucked away, hair tied back and don't wear loose clothing that may get tangled.

Cut list The measurements used in this project can be changed to suit your requirements.

- 45mm x 45mm timber
- 2 x 225mm
- 1 x 750mm1 x 525mm
- 1 x 325mm
- 25mm plywood
- 3 x 240mm

Cost \$45 for timber and fixings. This excludes Resene products.

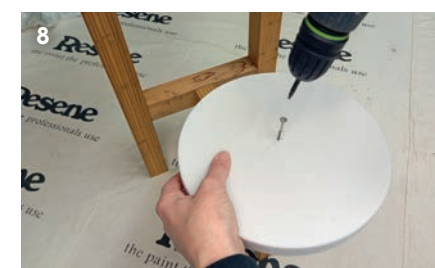
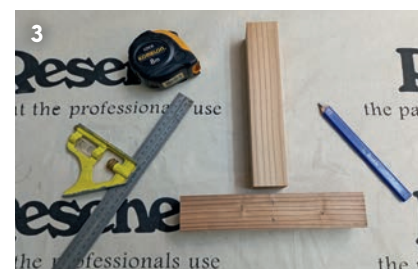

Step 1

Measure up your frame timbers and cut to size.

Step 2

Draw out your circles on the exterior plywood using a template like a bowl or plate. Cut circles with the jigsaw and sand the edges.

Step 3

Assemble the T-Brace. Measure out for the screws in the centre, pre-drill and screw together.

Step 4

Measure out for the screws for installing each tier, 200mm up from the bottom of each tier post.

Step 5

Pre-drill and screw together. I used a clamp to hold the timbers in place.

Step 6

Apply Resene exterior finish. I used Resene Furniture & Decking Oil Exterior to show off the timber.

Step 7

Using brush or roller apply paint each side of plant stand circles. I have used Resene Walk-On Flooring & Paving paint for durability.

Step 8

Measure to the centre of each circle and pre-drill. Attach the circles to the centre of the top of each tier post. ■



Jane Horne and partner Simon Bartholomew design and develop projects from their studio (plainandsimple.co.nz) in Christchurch, managing projects throughout the South Island.