

make your own courier box

Keep daytime deliveries secure with this simple to build box that doubles as a seat.

top tip

Use letter stencils to label your courier box or decorate it with fun patterns using Resene testpots.

you will need:

- 1 sheet 2.4m x 1.2m x 12mm thick plywood
- 22mm² x 1.2m long pine trim (optional)
- Measuring tape and/or long ruler
- Pencil
- Nouveau Outdoor Cushion in Blue Heaven (from Mitre 10, www.mitre10.co.nz)
- Table saw or similar
- Jig saw or similar
- Router or similar (optional)
- Electric sander and sanding block
- Electric drill
- Screwdriver
- 20mm long wood screws
- Wood putty
- 2 x 75mm hinges
- 62mm hasp and staple
- 30mm set-your-own-combination padlock
- Adhesive hook and loop strips
- Needle and thread
- Clean, dry cloth
- Resene Lustacryl in a colour of your choice – we used Resene Eighth Truffle
- Resene Quick Dry primer sealer undercoat

Above and right: Courier box in Resene Eighth Truffle, wall in Resene Hammerhead, deck stained in Resene Woodsman Mid Greywash, trim in Resene Half Sea Fog and plant pots in (from left to right) Resene Bismark, Resene Hemisphere and Resene Aviator.

project Laura Lynn Johnston
images Bryce Carleton, Ben Whorwood

Resene Eighth Truffle 

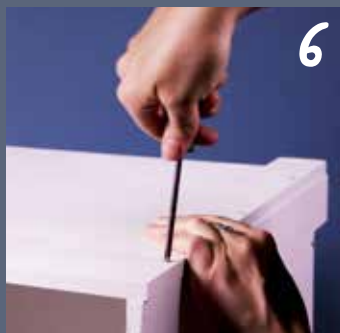

Step 1: Download the cut plan and measurements from www.habitatbyresene.com/news/diy-courier-box, which has been designed to minimise waste and the number of cuts. Measure and cut your plywood using a table saw and jig saw or similar. While you will not need a full sheet of plywood for the project, you will need a minimum surface area of 925mm x 140mm – so feel free to reuse an offcut section from another project if it is large enough. If you would like your courier box to also have a letter slot, you may choose to use a router to give the opening rounded edges.

Step 2: Fill any holes or knots with wood putty and allow it to dry before sanding down all surfaces with an electric sander and/or by hand with a sanding block. Remove any dust by wiping down the entire box with a clean, dry cloth.

Step 3: Prime with Resene Quick Dry then apply two coats of Resene Lustacryl in a colour of your choice – we used Resene Eighth Truffle, a warm mushroom white – allowing each coat to dry completely before painting on the next one.

Step 4: Using an electric drill, drill holes 50mm, 200mm and 250mm from the top edge and 6mm in from the sides down the sides of the front and back panels. Then, drill holes 20mm in and 6mm up from the corner 'notches' you've cut into the bottom (which will become the feet of your box).

Optional: Attach the decorative trim to the top of the box lid with 20mm long screws attached through the bottom of the lid so that it creates a frame for where your cushion will sit.

Step 5: Drill approx. 5mm into the centre of the sides of your box 50mm, 200mm and 250mm from the top edge along each vertical side.

Step 6: Using a screwdriver, assemble your box with 20mm wood screws, through the front and back into the sides and base.

Step 7: Attach the hasp and staple to the front of your box and lid. Use 12mm long wood screws to secure them in place.

Step 8: Attach the bottom of your lid to the back side of your box with hinges secured with 12mm long wood screws. Depending on the type of hinges you choose, you may need to install them on the inside or outside.

Step 9: Using a small artist's brush, paint the tops of the screws and your hardware in the same colour of Resene Lustacryl that you used for the rest of the box and touch up any areas as needed.

Step 10: Apply one side of the hook and loop adhesive strips to the top of your box lid and use your needle and thread to attach the other side to the base of your cushion. This will help to keep it in place when the lid is both opened and closed. [H](#)

